



Elevation A

LibertyHomesVA.com

The Monticello

Renderings and Plans are for marketing purposes only and are shown with additional options including siding. This information is deemed accurate, but cannot be guaranteed. Builder reserves the right to make changes at any time.

The Monticello Optional Elevations



Elevation B

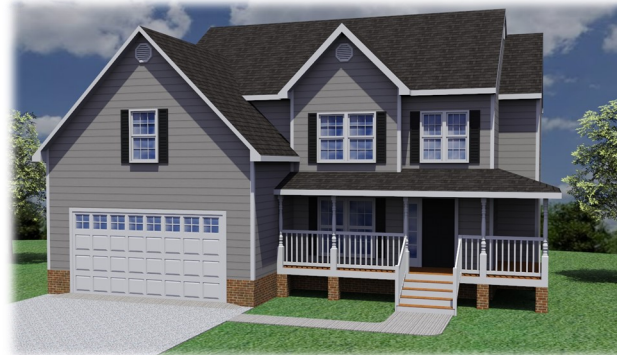

Elevation C

ADDITIONAL ELEVATIONS SHOWN W/ SHAKE, BOARD AND BATTEN, AND/OR ARCHITECTURAL GABLE ACCENTS



Elevation A



Elevation B



Elevation A



Elevation B

Renderings and Plans are for marketing purposes only and are shown with additional options including siding. This information is deemed accurate, but cannot be guaranteed. Builder reserves the right to make changes at any time.

The Monticello Floor Plan

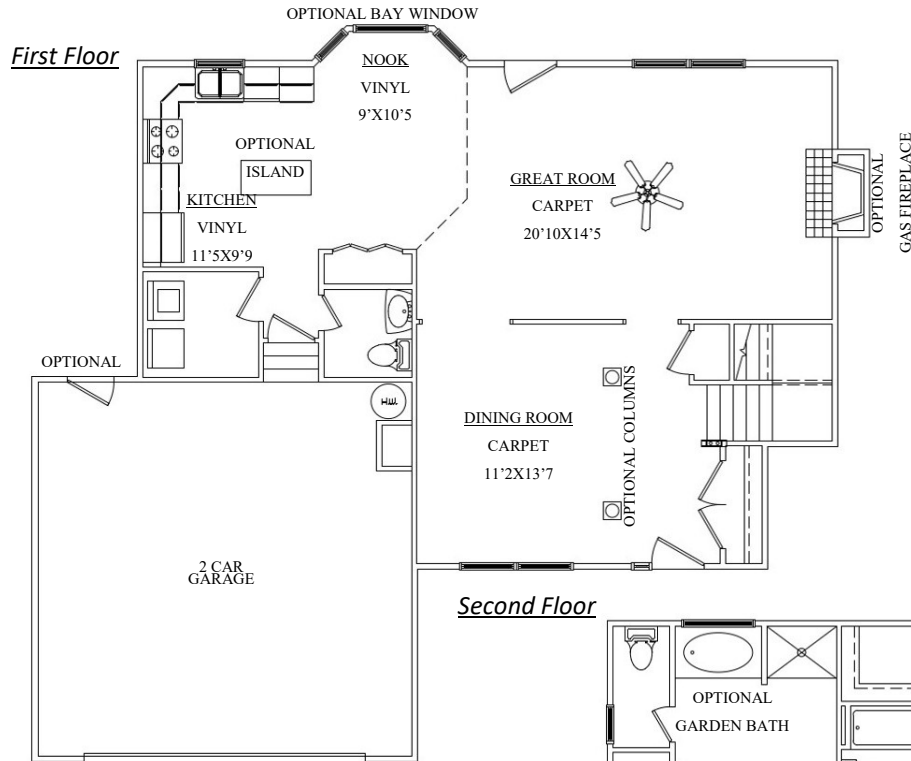

Second Floor

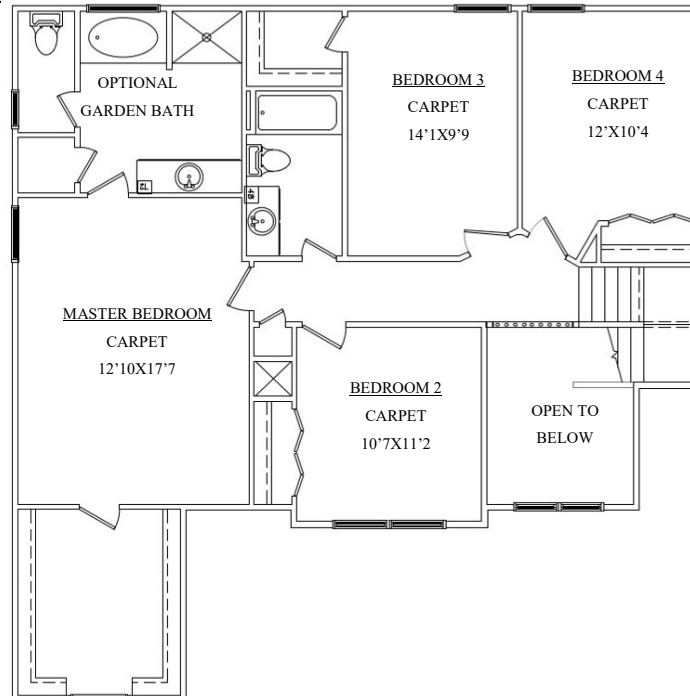

Liberty Homes, Inc.
8249 Crown Colony Parkway
Mechanicsville, VA 23116

Phone: (804) 730-7770
LibertyHomesVA.com



2218 Finished Square Feet
4BR/2.5BA
Optional Garden Bath
2 Car Garage

Renderings and Plans are for marketing purposes only and are shown with additional options including siding. This information is deemed accurate, but cannot be guaranteed. Builder reserves the right to make changes at any time.